

Fixed monobeam spreaders

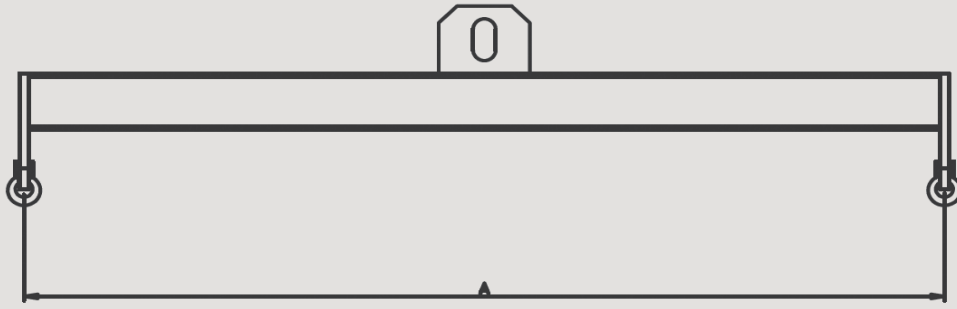

'Fixed monobeam spreaders are made in the Italy from steel and painted for indoor or out door use to our customers' specification. All our 'H' shape Lifting beams are made to order and therefore the design and lifting capacity can be modified to suit your individual requirements.

MODEL	CAPACITY	A	MODEL	CAPACITY	A
	KG	(mm)		KG	(mm)
BF-12	1000	2000	BF-52	5000	2000
BF-13	1000	3000	BF-53	5000	3000
BF-14	1000	4000	BF-54	5000	4000
BF-15	1000	5000	BF-55	5000	5000
BF-16	1000	6000	BF-56	5000	6000
BF-22	2000	2000	BF-63	6000	3000
BF-23	2000	3000	BF-64	6000	4000
BF-24	2000	4000	BF-65	6000	5000
BF-25	2000	5000	BF-66	6000	6000
BF-26	2000	6000			
BF-32	3000	2000	BF-83	8000	3000
BF-33	3000	3000	BF-84	8000	4000
BF-34	3000	4000	BF-85	8000	5000
BF-35	3000	5000	BF-86	8000	6000
BF-36	3000	6000			
BF-42	4000	2000	BF-103	10000	3000
BF-43	4000	3000	BF-104	10000	4000
BF-44	4000	4000	BF-105	10000	5000
BF-45	4000	5000	BF-106	10000	6000
BF-46	4000	6000			
			BF-154	15000	4000
			BF-155	15000	5000
			BF-156	15000	6000

Adjustable monobeam spreaders

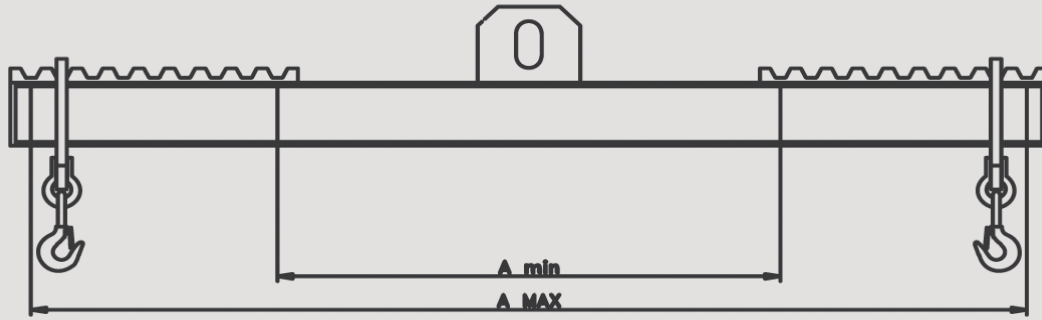

This device is suited with swivel hooks with forged safety clips to generate the tool more efficiently.

MODEL	CAPACITY	L	A MAX	A MIN	MODEL	CAPACITY	L	A MAX	A MIN
	KG	(mm)	(mm)	(mm)		KG	(mm)	(mm)	(mm)
BR-12	1000	2100	2000	1000	BR-52	5000	2100	2000	1000
BR-13	1000	3100	3000	1500	BR-53	5000	3100	3000	1500
BR-14	1000	4100	4000	2000	BR-54	5000	4100	4000	2000
BR-15	1000	5100	5000	2500	BR-55	5000	5100	5000	2500
BR-16	1000	6100	6000	3000	BR-56	5000	6100	6000	3000
BR-22	2000	2100	2000	1000	BR-63	6000	3100	3000	1500
BR-23	2000	3100	3000	1500	BR-64	6000	4100	4000	2000
BR-24	2000	4100	4000	2000	BR-65	6000	5100	5000	2500
BR-25	2000	5100	5000	2500	BR-66	6000	6100	6000	3000
BR-26	2000	6100	6000	3000					
BR-32	3000	2100	2000	1000	BR-83	8000	3100	3000	1500
BR-33	3000	3100	3000	1500	BR-84	8000	4100	4000	2000
BR-34	3000	4100	4000	2000	BR-85	8000	5100	5000	2500
BR-35	3000	5100	5000	2500	BR-86	8000	6100	6000	3000
BR-36	3000	6100	6000	3000					
BR-42	4000	2100	2000	1000	BR-103	10000	3100	3000	1500
BR-43	4000	3100	3000	1500	BR-104	10000	4100	4000	2000
BR-44	4000	4100	4000	2000	BR-105	10000	5100	5000	2500
BR-45	4000	5100	5000	2500	BR-106	10000	6100	6000	3000
BR-46	4000	6100	6000	3000					
					BR-154	15000	4100	4000	2000
					BR-155	15000	5100	5000	2500
					BR-156	15000	6100	6000	3000

Fixed monobeam spreaders and Adjustable monobeam spreaders

MODEL ELSF

LIFTING BEAMS (FIXED POSITION)

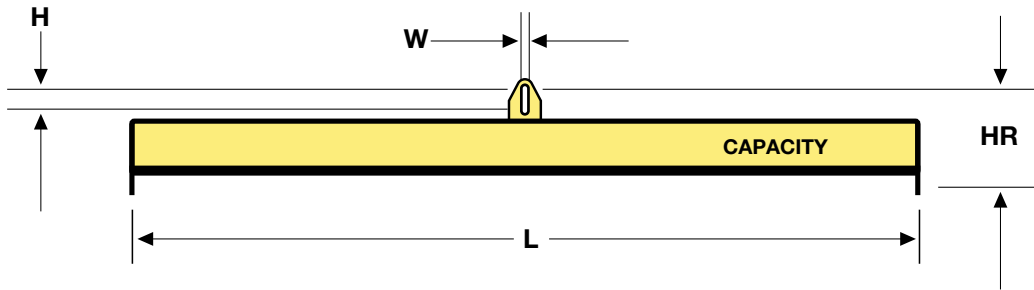

Lifting Beams have single upper lift points that are well-suited to lighter, shorter span lifts that have a limited headroom requirement, such as in smaller manufacturing shops or storage

type facilities. Every Beam is engineered to be user friendly with the highest standards of safety and durability. The data table below lists the basic standard lifting beam offering.

- A wide range of sizes, dimensions, capacities and configurations are available upon request.
- Refer to the Beam Options on page 6 for additional accessories and capabilities.
- Beam profiles vary based on capacities.

MODEL*	CAPACITY (tons)	LENGTHS (L)** (ft.)	HEADROOM (HR) (in.)	LIFT BAILE*** W x H (in.)	WEIGHT**** (lbs. @ max. L)
ELS025	1/4	4-6-8-10	8	1.00 x 2.25	30
ELS050	1/2	5-6-8-10-12	10	1.25 x 2.75	90
ELSF1	1	5-6-8-10-12	12	1.25 x 2.75	210
ELSF2	2	8-10-12-20	14	1.25 x 3.25	480
ELSF3	3	8-10-12-20	16	1.50 x 4.00	650
ELSF4	4	8-10-12-20	18	2.00 x 4.75	730
ELSF5	5	8-10-12-16-20-24	20	2.25 x 4.75	1,250
ELSF8	8	8-10-12-16-20-24	22	2.50 x 6.00	1,575
ELSF10	10	8-10-12-16-20-24-30	24	2.50 x 6.25	2,625
ELSF12	12	8-10-12-16-20-24-30	26	2.75 x 7.00	4,150
ELSF15	15	10-12-16-20-24-30	28	2.75 x 7.50	4,775
ELSF20	20	10-12-16-20-24-30-40	30	3.50 x 9.00	5,700
ELSF25	25	12-16-20-24-30-40	32	3.50 x 12.00	6,800
ELSF30	30	12-16-20-24-30-40	34	3.75 x 13.00	7,875
ELSF40	40	20-24-30-40	36	4.50 x 15.00	9,800
ELSF50	50	20-24-30-40	38	4.75 x 17.00	12,000
ELSF75	75	20-24-30-40	40	4.75 x 17.00	15,800
ELSF100	100	20-24-30-40	42	6.00 x 18.00	20,300
ELSF125	125	20-24-30-40	45	6.50 x 18.50	24,000

* Model Number Code: LB = Style (Lifting Beam), followed by capacity and then length.
 ** Lengths (L): expressed in a range of standard lengths available.
 *** Lift Bail: Lower Bail hole dia. per Crosby Shackle sizes by capacity.
 **** Weight: shown for the maximum length (L) in range.
 2000 lbs. = 1 Ton. 2205 lbs. = 1 (metric) tonne.

For dimensions and other requirements not offered here, please contact our knowledgeable sales team for a quick quote based upon the specific job application.

MODEL ELSBF

SPREADER BEAMS (FIXED POSITION)

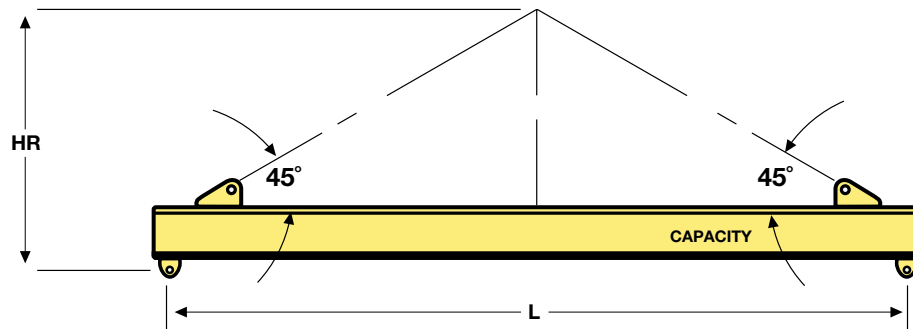

Spreader Beams efficiently distribute the weight of a load between two lifting points and are effective at lifting loads with large spans where headroom is not limited. They add a measure of stability and are ideal

for lifting heavy duty loads. Every Beam is engineered to be user friendly with the highest standards of safety and durability. The data table below lists the basic standard, fixed position, spreader beam offering.

- A wide range of sizes, dimensions, capacities and configurations are available upon request.
- Refer to the Beam Options on page 6 for additional accessories and capabilities.
- The actual spread of the lower Lugs will be slightly less than the length of the beam.
- Designed for a 45° Sling Angle. 30° to 60° available on request.
- Complies with ASME Standards.
- Rigging available on request.

MODEL*	CAPACITY (tons)	LENGTHS (L)** (ft)	HEADROOM (HR) (in.)	LIFT BALES*** (hole dia.) (in.)	WEIGHT**** (lbs. @ max. L)
ELSBF025	1/4	4-6-8	57-5/8	0.313 / 0.313	40
ELSBF050	1/2	4-6-8	57-5/8	0.375 / 0.313	50
ELSBF1	1	4-6-8-10-12	86-7/16	0.500 / 0.375	65
ELSBF2	2	4-6-8-10-12	86-7/16	0.750 / 0.500	105
ELSBF3	3	8-10-12-16-20	144	1.000 / 0.625	300
ELSBF4	4	8-10-12-16-20	144	1.000 / 0.750	350
ELSBF5	5	10-12-16-20-24	172-3/4	1.125 / 0.875	425
ELSBF8	8	10-12-16-20-24-30	216	1.250 / 1.000	500
ELSBF10	10	12-16-20-24-30	216	1.375 / 1.000	575
ELSBF12	12	12-16-20-24-30	216	1.500 / 1.125	625
ELSBF15	15	16-20-24-30-40	288	1.750 / 1.250	950
ELSBF20	20	16-20-24-30-40	288	2.250 / 1.375	1,200
ELSBF25	25	16-20-24-30-40	288	2.250 / 1.500	1,250
ELSBF30	30	16-20-24-30-40	288	2.500 / 1.750	1,325
ELSBF40	40	16-20-24-30-40	288	3.000 / 2.250	1,400
ELSBF50	50	16-20-24-30-40	288	3.000 / 2.250	1,500

* Model Number Code: SB = Style (Spreader Beams), followed by capacity and then length

** Lengths: Shown in a range of standard lengths available.

*** Lift Bales: Lifting holes for "Upper/Lower" sling rigging are based on Crosby® shackle sizes.

**** Weight: Shown is for the maximum length (L) in the range.

2000 lbs. = 1 Ton. 2205 lbs. = 1 (metric) tonne.

For dimensions and other requirements not offered here, please contact our knowledgeable sales team for a quick quote based upon the specific job application.

MODEL ELSLBA AND ELSBA

Adjustable Lifting and Spreader Beams are versatile lifting devices offering multiple upper and lower lifting points capable of handling various size loads and unbalanced loads. The illustrations below display the standard

LIFTING/SPREADER BEAMS (ADJUSTABLE POSITION)

adjustable lifting and spreader beam models available. Choose a model that best fits the specific job application and provide the lengths, spreads, number and configuration of adjustment positions and capacity desired.

LIFTING BEAMS ADJUSTABLE

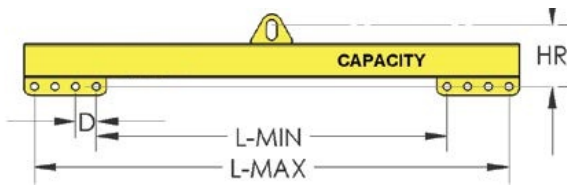

Model ELSLBA-MH

Lifting Beam, Adjustable, Multi-Hole

SPREADER BEAMS ADJUSTABLE

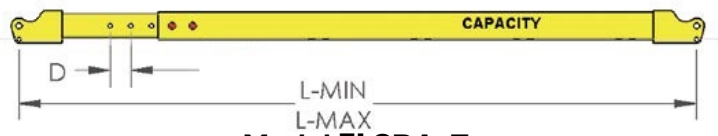

Model ELSBA-T

Spreader Beam, Adjustable, Telescoping

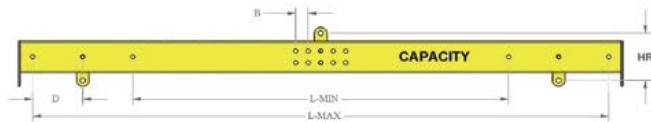

Model ELSLBA-SB

Lifting Beam, Adjustable, Sliding Bale

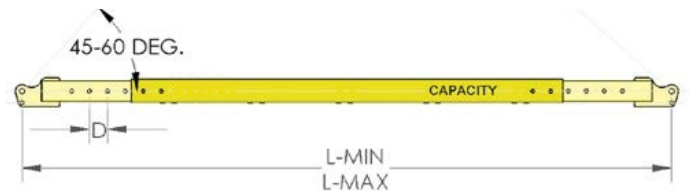

Model ELSBA-DT

Spreader Beam, Adjustable, Dual Telescoping

LIFTING/SPREADER BEAMS ADJUSTABLE

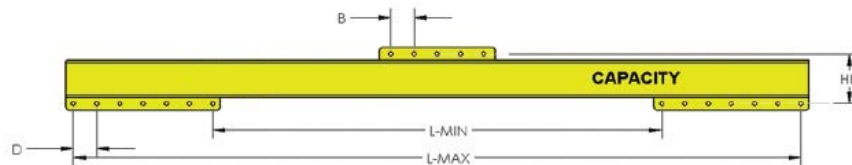

Model ELSLSBA-MH

Lifting/Spreader Beam, Adjustable, Multi-Hole

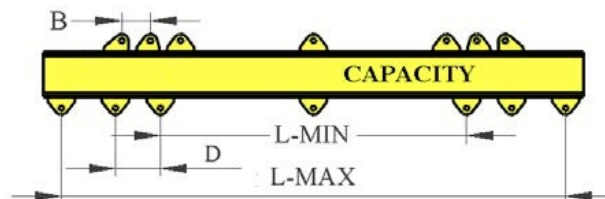

MODEL ELSLBA AND ELSBA

Lifting/Spreader Beam, Adjustable, Multi-Bale

For dimensions and other requirements not offered here, please contact our knowledgeable sales team for a quick quote based upon the specific job application.